



6W AC-DC Single Output Wall-mounted type

GS06E-11P5A



■ Features :

- Universal AC input / Full range
- No load power consumption <0.3W
- ErP step2 compliant
- Meet EISA 2007 (Energy Independence and Security Act)
- 2 pole EURO plug
- Class II power (without earth pin)
- Protections: Short circuit / Overload / Over voltage
- Pass LPS
- Fully enclosed plastic case
- Approvals: TUV / CB / FCC / CE
- 2 years warranty



SPECIFICATION

ORDER NO.		GS06E-11P5A	
OUTPUT	SAFETY MODEL NO.	GPSU06E-1-1	
	DC VOLTAGE Note.2	7.5V	
	RATED CURRENT	0.8A	
	CURRENT RANGE	0 ~ 0.8A	
	RATED POWER	6W	
	RIPPLE & NOISE (max.) Note.3	80mVp-p	
	VOLTAGE ADJ. RANGE		6 ~ 8V
			Fixed
	VOLTAGE TOLERANCE Note.4	±5.0%	
	LINE REGULATION Note.5	±0.5%	
LOAD REGULATION Note.6	±5.0%		
SETUP, RISE, HOLD UP TIME	1000ms, 50ms, 12ms at full load		
INPUT	VOLTAGE RANGE	90 ~ 264VAC 127 ~ 370VDC	
	FREQUENCY RANGE	47 ~ 63Hz	
	EFFICIENCY (Typ.) Note.7	74%	
	AC CURRENT	0.2A / 100VAC	
	INRUSH CURRENT (max.)	50A / 230VAC	
LEAKAGE CURRENT(max.)	0.25mA / 240VAC		
PROTECTION	OVERLOAD	>110% rated output power Protection type : Hiccup mode, recovers automatically after fault condition is removed	
	OVER VOLTAGE	>120% rated output power Protection type : Clamp by zener diode	
ENVIRONMENT	WORKING TEMP.	0 ~ +40°C (Refer to "Derating Curve")	
	WORKING HUMIDITY	20% ~ 90% RH non-condensing	
	STORAGE TEMP., HUMIDITY	-20 ~ +85°C, 10 ~ 95% RH	
	TEMP. COEFFICIENT	±0.03% / °C (0 ~ 50°C)	
	VIBRATION	10 ~ 500Hz, 2G 10min./1cycle, period for 60min. each along X, Y, Z axes	
SAFETY & EMC (Note. 8)	SAFETY STANDARDS	EN60950-1 approved	
	WITHSTAND VOLTAGE	I/P-O/P:4242VDC	
	ISOLATION RESISTANCE	I/P-O/P:100M Ohms / 500VDC / 25°C / 70% RH	
	EMC EMISSION	Compliance to EN55022, EN61000-3-2,3, FCC Part15 class B	
	EMC IMMUNITY	Compliance to EN61000-4-2,3,4,5,6,11, light industry level, criteria A	
OTHERS	MTBF	500Khrs min. MIL-HDBK-217F(25°C)	
	DIMENSION	32*66*42.5mm (L*W*H)	
CONNECTOR	PACKING	100g ; 90pcs / 10Kg / CARTON	
	PLUG	See page 2	
	CABLE	See page 2	
NOTE	<p>1. All parameters are specified at 230VAC input, rated load, 25°C 70% RH ambient. 2. DC voltage: The output voltage set at point measure by plug terminal & 50% load. 3. Ripple & noise are measured at 20MHz by using a 12" twisted pair terminated with a 0.1uf & 47uf capacitor. 4. Tolerance: includes set up tolerance, line regulation, load regulation. 5. Line regulation is measured from low line to high line at rated load. 6. Load regulation is measured from 0% to 100% rated load 7. Efficiency is measured at 230VAC. 8. The power supply is considered as an independent unit, but the final equipment still need to re-confirm that the whole system complies with the EMC directives.</p>		

■ Mechanical Specification

Unit:mm

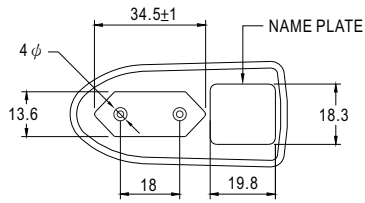

■ Plug Assignment

P5A	
P/N	OUTPUT
CENTER	+

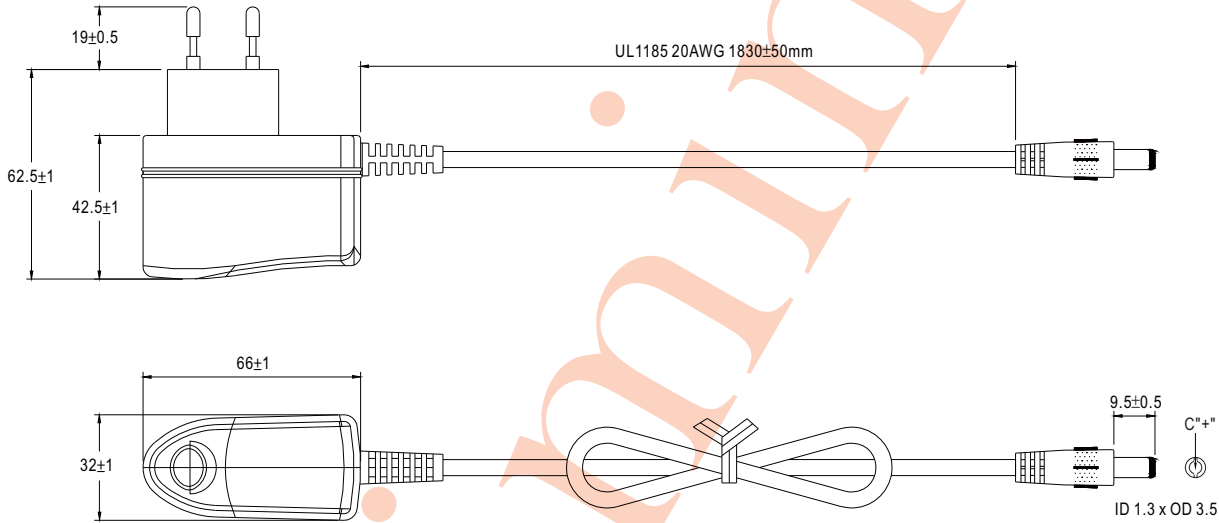

■ Derating Curve

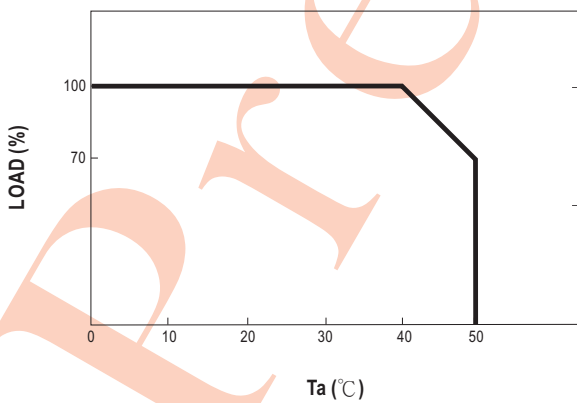

■ Static Characteristics

